



# LOGITRANS

HL / EHL

60 years experience with  
**LIFTING PERFORMANCE**

[logitrans.com](http://logitrans.com)

## Manual/electric highlifter - optimum working height

The highlifter can transport and lift a pallet to the right ergonomic working height: Loads of 1500 kg can be transported and lifted up to 470 mm. From 470 mm the lifting capacity is 1000 kg.

The ergonomic working conditions of the user is in focus. The working height can be varied up to 800 mm, and the user is given the opportunity for individual height adjustment, protecting his back and shoulders. Lifting is done either manually (HL) or electrically (EHL).

The electric highlifter can be provided with remote control and level control, automatically maintaining a correct working height, so that the user is constantly provided an ergonomically correct working position. Using the level control, the forks raise automatically when unloading material and lower when loading material.



# LOGITRANS

## HL / EHL

### Ergonomics

- The working height can be adjusted
- Ergonomically correct handle
- Very low power for pump function (HL)/ electric pump function (EHL)

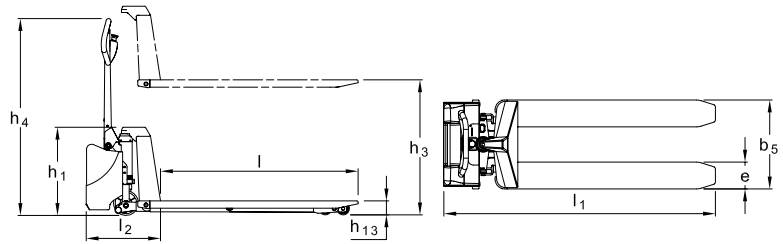

### Safety

- Foot protection
- Low overall height
- Supporting feet at steering wheel
- Tandem wheels on scissors legs

### Durability

- Long operating life
- Low maintenance costs
- Reliable cylinder construction
- Strong construction



The emergency stop is centrally placed on the electric highlifter. The forks stop quickly and precisely.



The manual highlifter needs very low power for the pump function and has foot protection and neutral position.



Ergonomic handle ensures the user a relaxed hold. Central location of all control buttons in the handle.



The tandem wheels have a brake effect and are gentle to the floor.



Level control (optional extra) ensures a constant working height.



Available as manual, electric, stainless and explosion proof.

Product (measured in mm)		HL 1006					EHL 1004				
Capacity in kg		1500*				1000	1500*				1000
Lifting height	$h_3$	500	600	800	800	800	500	600	800	800	800
Fork length	$l$	700	900	1200	1520	2000	700	900	1200	1520	2000
Overall height	$h_1$	540					540				
Fork span	$b_5$	480, 540, 680				540, 680	480, 540, 680				540, 680
Length without forks	$l_2$	356					451				
Overall length	$l_1$	1056	1256	1556	1876	2356	1151	1351	1651	1971	2451
Overall height with handle	$h_4$	1225					1195				
Lowered height	$h_{13}$	85			90		85			90	
Fork width	$e$	163					163				
Turning angle of the wheels		230°					180°				
Gangway	$A_{St}$	1830 (pallet: 1200 x 800)					1890 (pallet: 1200 x 800)				
Lifting speed with/without load		-					0,05/0,08 m/s				
Lifting speed normal/quick		10/35 mm per pump					-				
Lowering speed		Without load 0,093 m/s					With / without load: 0,07/0,05 m/s				
Pump motor		-					1,2 kW 12 V				
Weight with 1200 mm forks		95 kg					104 kg (no battery)				

\* The capacity changes from 1500 to 1000 kg at the lifting height 470 mm.